

**KNOTWOOD™**



Detail Drawings Library

# Interlocking Boards

Knotwood Australia

01.12.25



Interlocking Starter	1.	Joiner	8.
Finishing Base & Cover Trims	2.	Window Head Trim	9.
Internal Corner - Vertical	3.	Z Trim	10.
External Corner - Vertical	4.	Window Jamb	11.
Internal Corner - Horizontal	5.	Window Reveal	12.
External Corner - Horizontal	6.	Door Head Trim	13.
135° Angle Corner	7.	Service Utility Box	14.
		Dimensional Starter	15.



## Detail - View

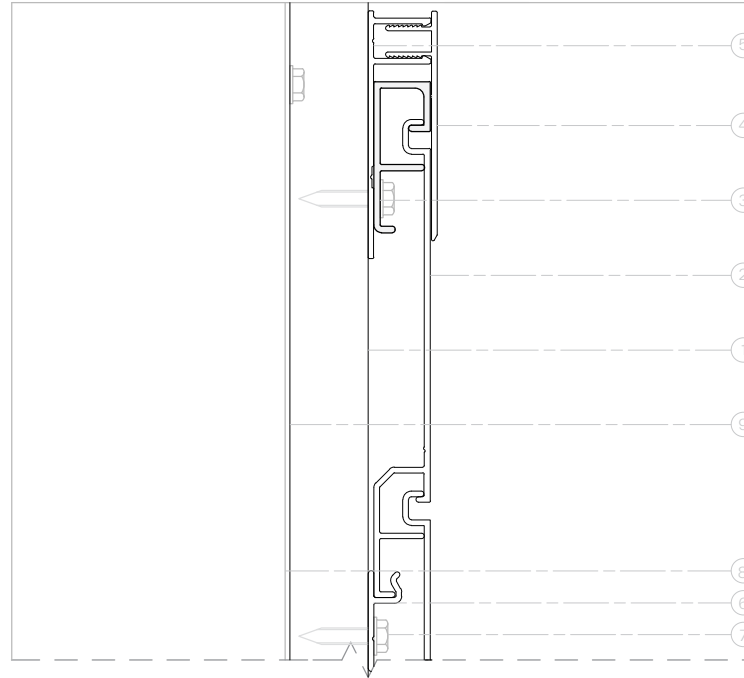

## Profiles



**KEDS**  
Interlocking - Starter



**KECFF**  
Base Trim - (F)



**KECFML**  
Cover Trim - Large - (M)



**KEC100S**  
Shadow Line Board - 100mm



**KECT9025**  
Standard Profile - Top Hat - 90 x 25mm

# KNOTWOOD™

Detail Drawings Library

## INTERLOCKING BOARDS

### Starter - Horizontal Cladding

## References

### Knotwood

- ① Standard Profile - Top Hat - 90 x 25mm - KECT9025
- ② Shadow Line Board - 100mm - KEC100S
- ③ Interlocking - Starter - KEDS
- ④ Cover Trim - Large - (M) - KECFML
- ⑤ Base Trim (F) - KECFF
- ⑥ Cladding Clip - 45mm - KACC

### 3rd Party

- ⑦ #10 x 5/8" Hex Washer Head Self-Drilling Screws
- ⑧ Building Substructure
- ⑨ Vapour Barrier / Building Envelope

## Drawing

Version: V-001  
Date: 01-Oct-2025

## Disclaimer

The information in this technical detail is given as a guide and is intended for use in relation to the relevant Knotwood products only. The customer's project designer is ultimately responsible for special design and detailing to ensure the product's use is fit for purpose. The customer's project designer needs to give extra consideration to product suitability to take into account any specialised factors of the project. This specification detail must be reviewed in conjunction with the relevant Knotwood product installation guide current at the time of installation, and all other relevant Knotwood product technical literature.



## Detail - View

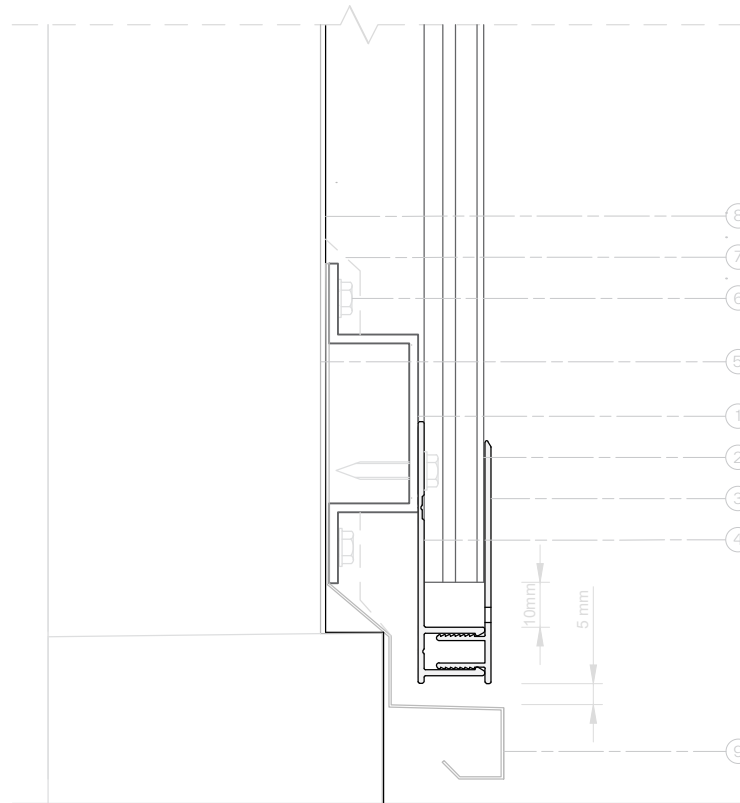

## Profiles

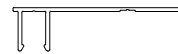

**KECFF**  
Base Trim - (F)



**KECFSML**  
Slotted Cover Trim - Large - (M)



**KEC150S**  
Shadow Line Board - 150mm



**KECT9025**  
Standard Profile - Top Hat - 90 x 25mm

# KNOTWOOD™

Detail Drawings Library

## INTERLOCKING BOARDS

Finishing Base & Cover Trims -  
Vertical Cladding

### References

#### Knotwood

- ① Standard Profile - Top Hat - 90 x 25mm - KECT9025
- ② Shadow Line Board - 150mm - KEC150S
- ③ Slotted Cover Trim - Large - (M) - KECFSML
- ④ Base Trim - (F) - KECFF

#### 3rd Party

- ⑤ Building Substructure
- ⑥ #10 x 5/8" Hex Washer Head Self-Drilling Screws
- ⑦ Flexible Sealant Tape
- ⑧ Vapour Barrier / Building Envelope
- ⑨ Construction Flashing (by other)

### Drawing

Version: V-001

Date: 01-Oct-2025

### Disclaimer

The information in this technical detail is given as a guide and is intended for use in relation to the relevant Knotwood products only. The customer's project designer is ultimately responsible for special design and detailing to ensure the product's use is fit for purpose. The customer's project designer needs to give extra consideration to product suitability to take into account any specialised factors of the project. This specification detail must be reviewed in conjunction with the relevant Knotwood product installation guide current at the time of installation, and all other relevant Knotwood product technical literature.

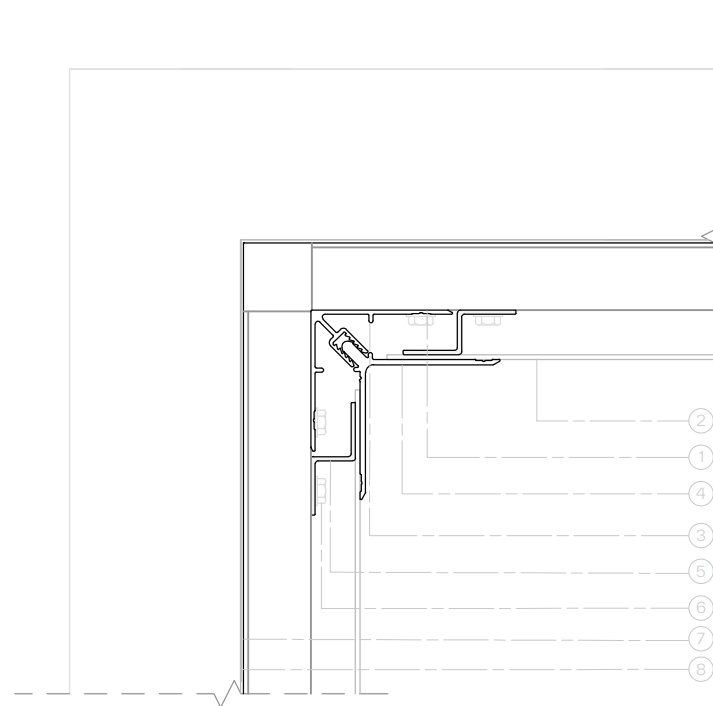

**INTERLOCKING BOARDS**

**Internal Corner (Z trim) - Vertical Cladding**

References

Knotwood

- ① Standard Profile - Top Hat - 3 1/2" x 1" - KECT9025
- ② Classic Board - 6" - KEC150
- ③ Reversible Corner Cover Trim - Square - 1 3/4" - (F) - KECCML-02
- ④ Reversible Base Corner Trim - (M) - KECCML
- ⑤ Standard Profile - Z - 3/4" - KECZ

3rd Party

- ⑥ #10 x 5/8" Hex Washer Head Self-Drilling Screws
- ⑦ Vapour Barrier / Building Envelope
- ⑧ Building Substructure

Drawing

Version: V-001  
Date: 01-Oct-2025

Profiles

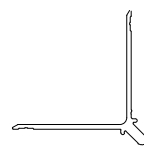

**KECCML**  
Reversible Base Corner Trim - (M)

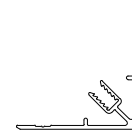

**KECCF-02**  
Reversible Corner Cover Trim - Square - 45mm - (F)

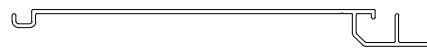

**KEC150S**  
Shadow Line Board - 150mm



**KECZ**  
Standard Profile - Z - 20mm

Disclaimer

The information in this technical detail is given as a guide and is intended for use in relation to the relevant Knotwood products only. The customer's project designer is ultimately responsible for special design and detailing to ensure the product's use is fit for purpose. The customer's project designer needs to give extra consideration to product suitability to take into account any specialised factors of the project. This specification detail must be reviewed in conjunction with the relevant Knotwood product installation guide current at the time of installation, and all other relevant Knotwood product technical literature.

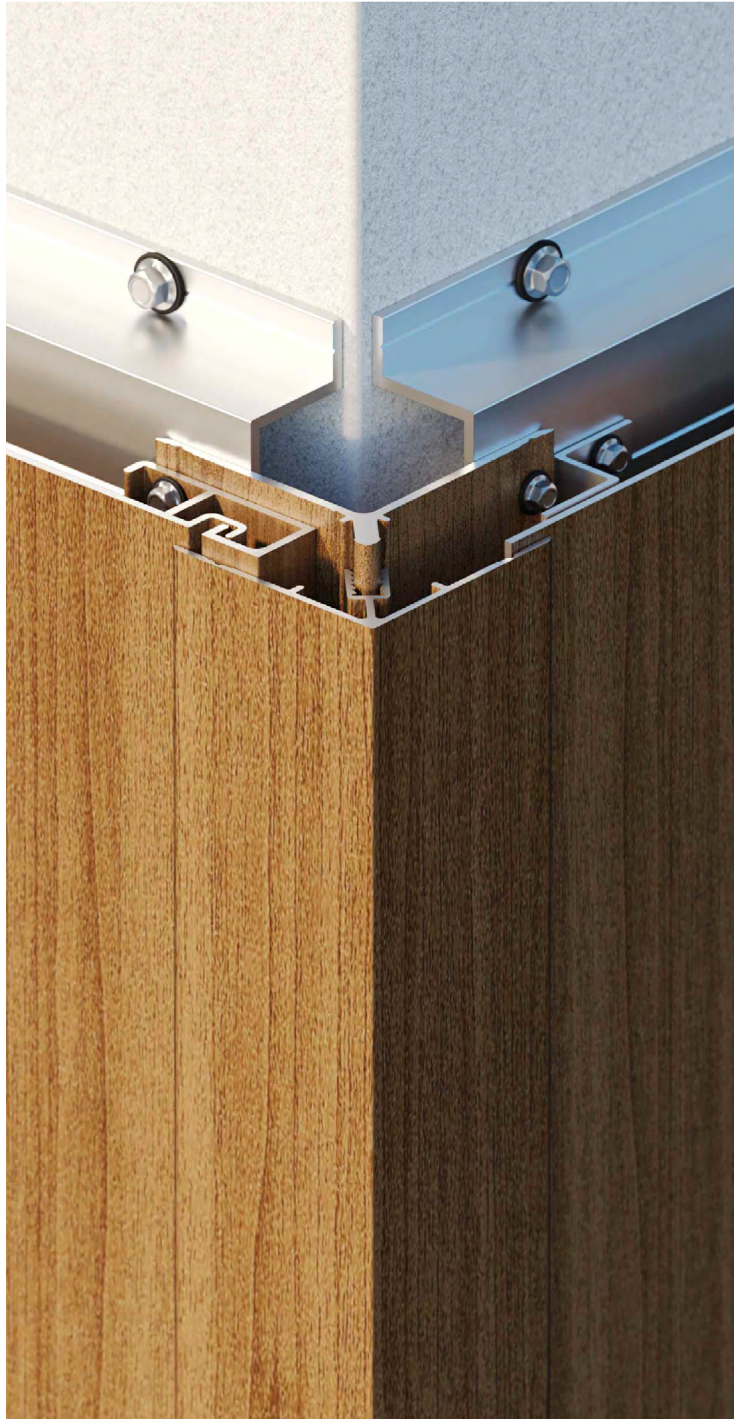

Detail - View

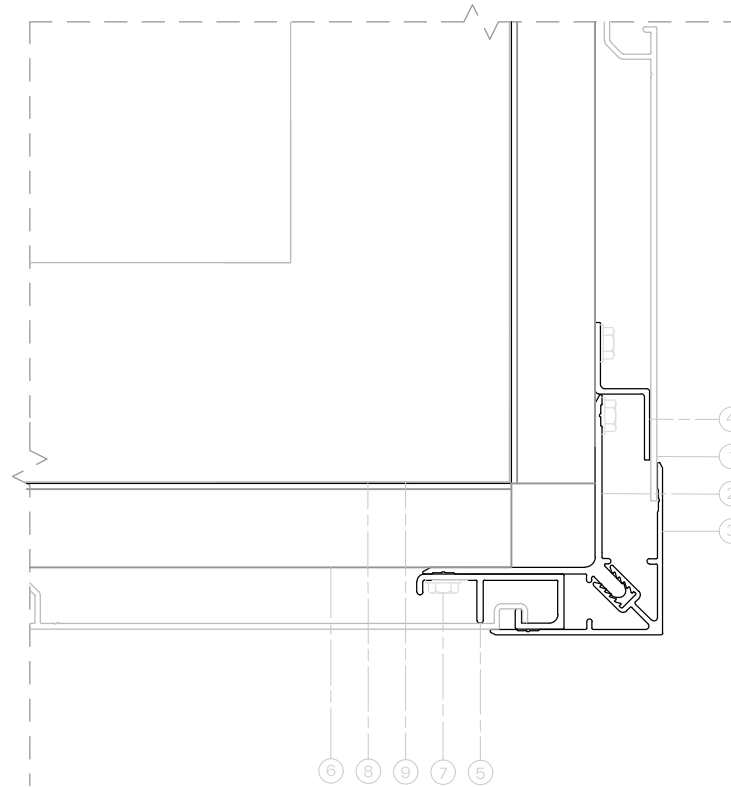

**KNOTWOOD™**

Detail Drawings Library

**INTERLOCKING BOARDS**

External Corner (Starter and Z trim) - Vertical Cladding

References

Knotwood

- ① Classic Board - 6" - KEC150
- ② Reversible Base Corner Trim - 2" (M) - KECCML
- ③ Reversible Corner Cover Trim - Square - 2" (F) - KECCF-02
- ④ Standard Profile - Z - 3/4" - KECZ
- ⑤ Interlocking - Starter - KEDS
- ⑥ Standard Profile - Top Hat - 90 x 25mm - KECT9025

3rd Party

- ⑦ #10 x 5/8" Hex Washer Head Self-Drilling Screws
- ⑧ Building Substructure
- ⑨ Vapour Barrier / Building Envelope

Drawing

Version: V-001  
Date: 01-Oct-2025

Profiles

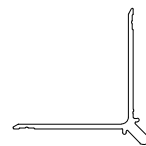

**KECCML**  
Cladding Trim - Corner - 50mm (M)

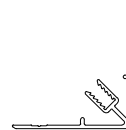

**KECCF-02**  
Reversible Corner Cover Trim - Square - 45mm (F)



**KEDS**  
Interlocking - Starter



**KEC150S**  
Shadow Line Board - 150mm



**KECZ**  
Standard Profile - Z - 3/4"

Disclaimer

The information in this technical detail is given as a guide and is intended for use in relation to the relevant Knotwood products only. The customer's project designer is ultimately responsible for special design and detailing to ensure the product's use is fit for purpose. The customer's project designer needs to give extra consideration to product suitability to take into account any specialised factors of the project. This specification detail must be reviewed in conjunction with the relevant Knotwood product installation guide current at the time of installation, and all other relevant Knotwood product technical literature.

**INTERLOCKING BOARDS**

Internal Corner - Horizontal Cladding

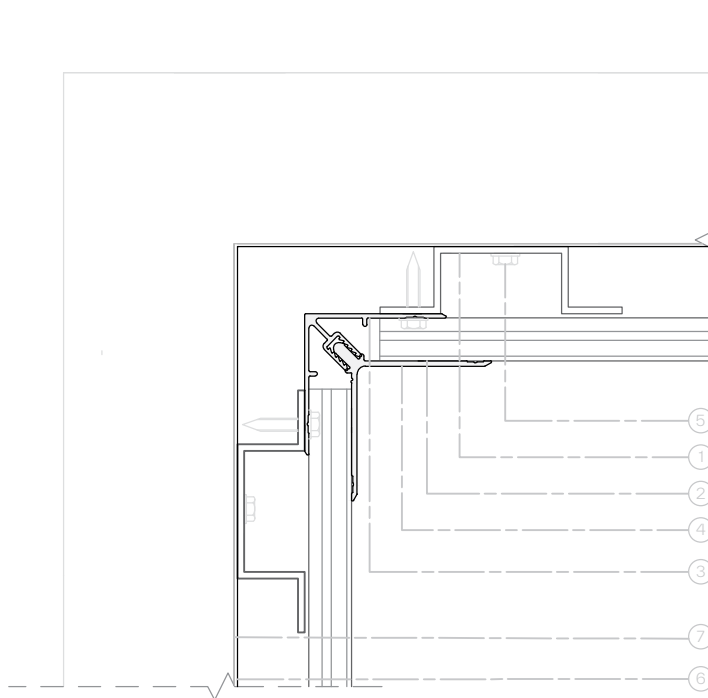
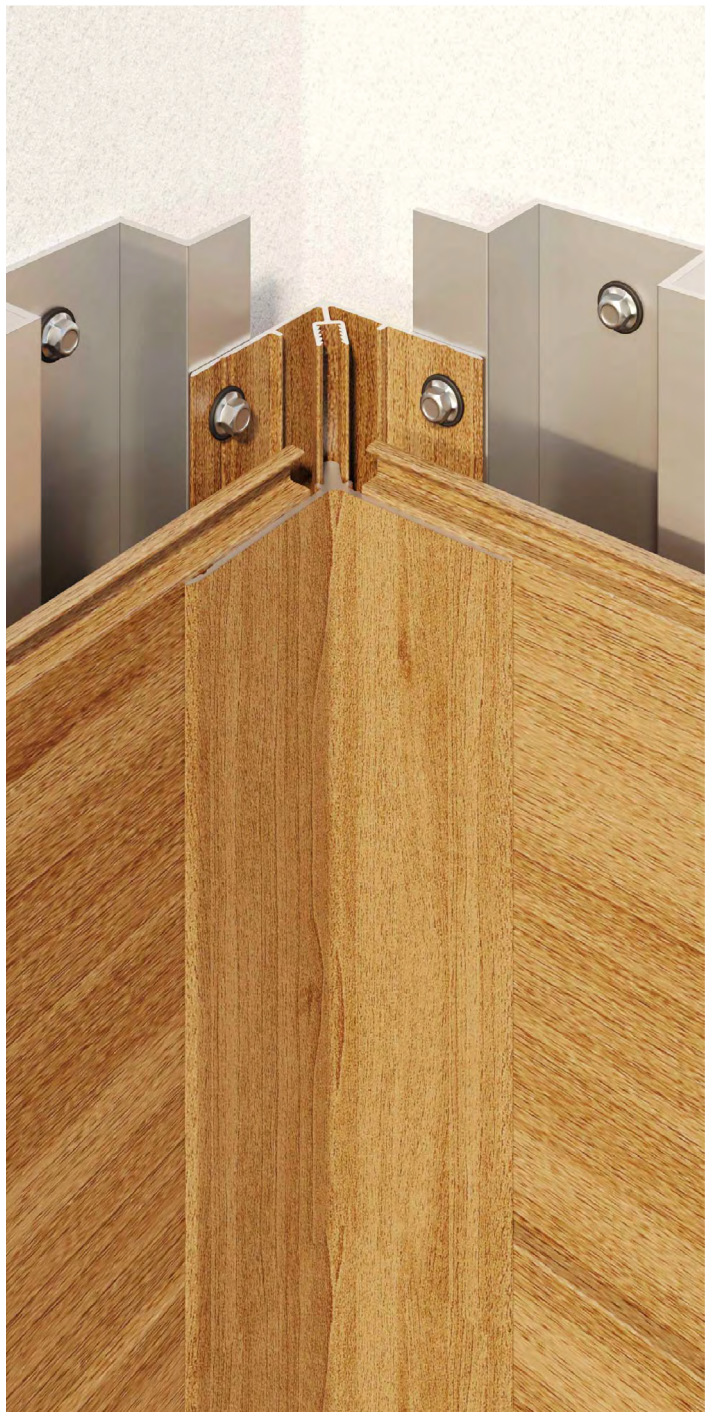

References

Knotwood

- ① Standard Profile - Top Hat - 90 x 25mm - KECT9025
- ② Shadow line Board - 150mm - KEC150S
- ③ Reversible Corner Cover Trim - Square - 45mm - (F) - KECCML-02
- ④ Reversible Base Corner Trim - (M) - KECCML

3rd Party

- ⑤ #10 x 5/8" Hex Washer Head Self-Drilling Screws
- ⑥ Vapour Barrier / Building Envelope
- ⑦ Building Substructure

Drawing

Version: V-001

Date: 01-Oct-2025

Profiles

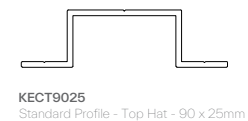
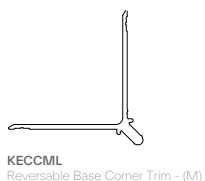

Disclaimer

The information in this technical detail is given as a guide and is intended for use in relation to the relevant Knotwood products only. The customer's project designer is ultimately responsible for special design and detailing to ensure the product's use is fit for purpose. The customer's project designer needs to give extra consideration to product suitability to take into account any specialised factors of the project. This specification detail must be reviewed in conjunction with the relevant Knotwood product installation guide current at the time of installation, and all other relevant Knotwood product technical literature.

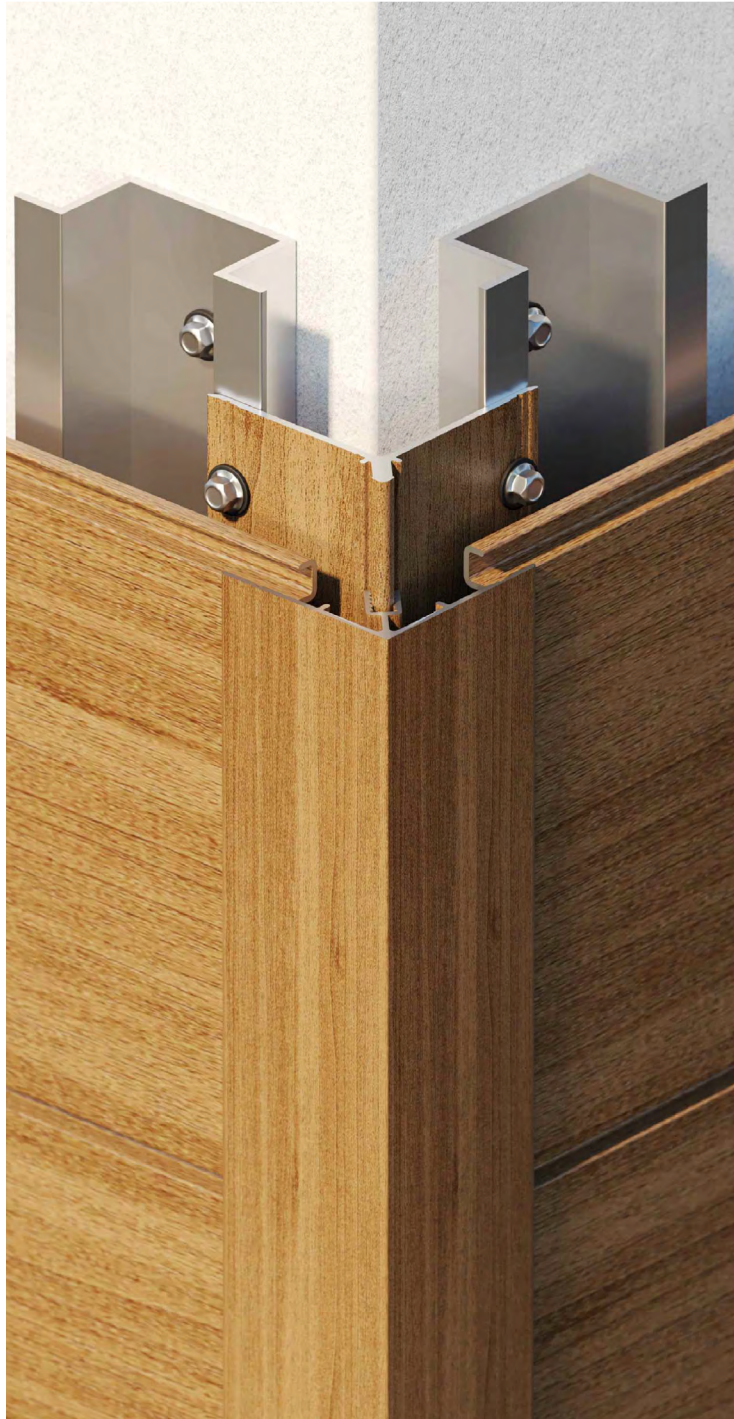

## Detail - View

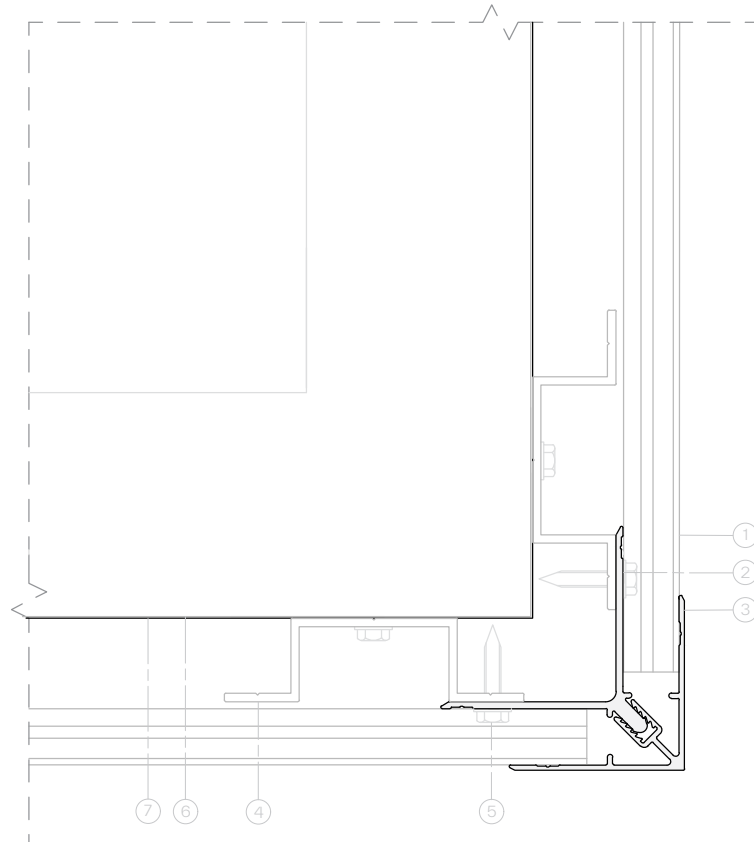

## Profiles

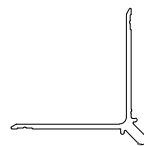

**KECCML**  
Reversible Corner Base Trim - (M)

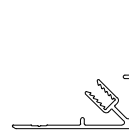

**KECCF-02**  
Reversible Corner Cover  
Trim - Square - 45mm (F)



**KEC150S**  
Shadow Line Board - 150mm



**KECT9025**  
Standard Profile - Top Hat - 90 x 25mm

# KNOTWOOD™

Detail Drawings Library

## INTERLOCKING BOARDS

External Corner - Horizontal Cladding

### References

#### Knotwood

- ① Classic Board - 6" - KEC150
- ② Reversible Base Corner Trim - 2" (M) - KECCML
- ③ Reversible Corner Cover Trim - Square - 2" (F) - KECCF-02
- ④ Standard Profile - Top Hat - 90 x 25mm - KECT9025

#### 3rd Party

- ⑤ #10 x 5/8" Hex Washer Head Self-Drilling Screws
- ⑥ Building Substructure
- ⑦ Vapour Barrier / Building Envelope

### Drawing

Version: V-001

Date: 01-Oct-2025

### Disclaimer

The information in this technical detail is given as a guide and is intended for use in relation to the relevant Knotwood products only. The customer's project designer is ultimately responsible for special design and detailing to ensure the product's use is fit for purpose. The customer's project designer needs to give extra consideration to product suitability to take into account any specialised factors of the project. This specification detail must be reviewed in conjunction with the relevant Knotwood product installation guide current at the time of installation, and all other relevant Knotwood product technical literature.

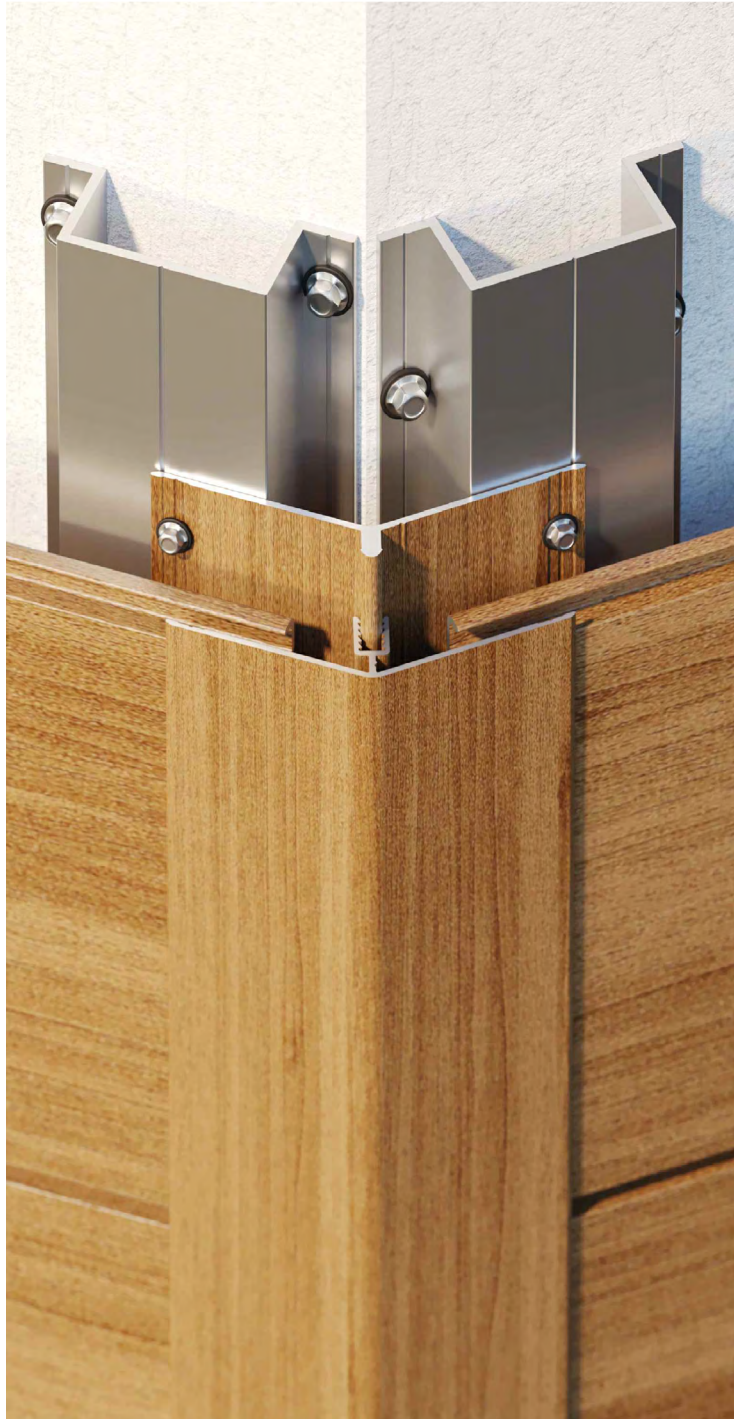

## Detail - View

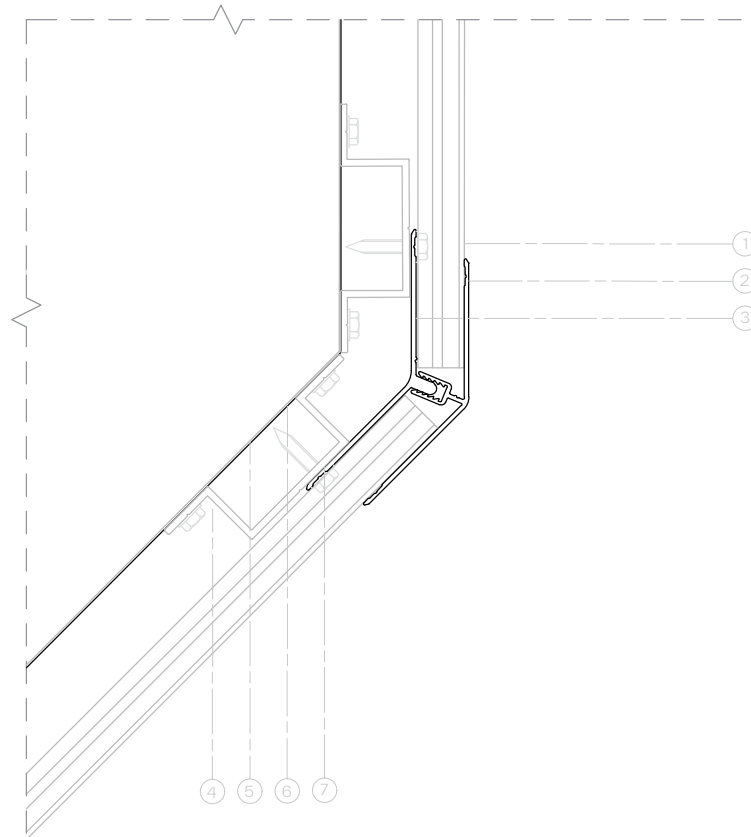

## Profiles

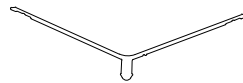

**KECCMA**  
Cover Corner Trim - 135° - 45mm - (M)

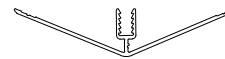

**KECCFA**  
Base Corner Trim - 135° - (F)



**KEC150S**  
Shadow Line Board - 150mm

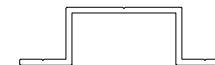

**KECT9025**  
Standard Profile - Top Hat - 90 x 25mm

# KNOTWOOD™

Detail Drawings Library

## INTERLOCKING BOARDS

135° Angle Corner - Horizontal Cladding

### References

#### Knotwood

- ① Shadow Line Board - 150mm - KEC150S
- ② Base Corner Trim - 135° - (F) - KECCFA
- ③ Cover Corner Trim - 135° - 45mm - (M) - KECCMA

#### 3rd Party

- ④ #10 x 5/8" Hex Washer Head Self-Drilling Screws
- ⑤ Building Substructure
- ⑥ Vapour Barrier / Building Envelope
- ⑦ Suitable Sub-Frame (by other)

### Drawing

Version: V-001

Date: 01-Oct-2025

### Disclaimer

The information in this technical detail is given as a guide and is intended for use in relation to the relevant Knotwood products only. The customer's project designer is ultimately responsible for special design and detailing to ensure the product's use is fit for purpose. The customer's project designer needs to give extra consideration to product suitability to take into account any specialised factors of the project. This specification detail must be reviewed in conjunction with the relevant Knotwood product installation guide current at the time of installation, and all other relevant Knotwood product technical literature.



## Detail - View

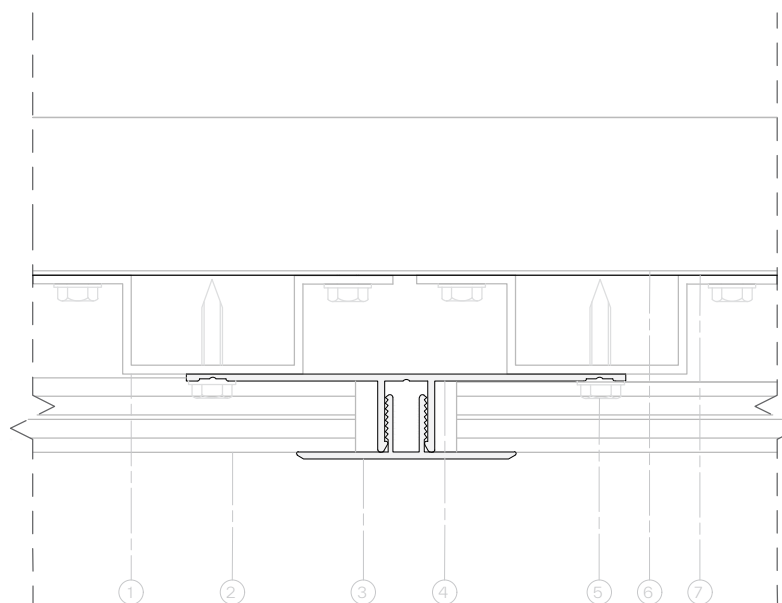

# KNOTWOOD™

Detail Drawings Library

## INTERLOCKING BOARDS

Joiner Trim - Horizontal Cladding

### References

#### Knotwood

- ① Standard Profile - Top Hat - 90 x 25mm - KECT9025
- ② Shadow Line Board - 150mm - KEC150S
- ③ Cover Joiner Trim - (M) - KECJM
- ④ Base Joiner Trim - (F) - KECJF

#### 3rd Party

- ⑤ #10 x 5/8" Hex Washer Head Self-Drilling Screws
- ⑥ Building Substructure
- ⑦ Vapour Barrier / Building Envelope

### Drawing

Version: V-001

Date: 01-Oct-2025

### Profiles



**KECJF**  
Base Joiner Trim - (F)

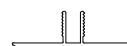

**KECJM**  
Cover Joiner Trim - (M)

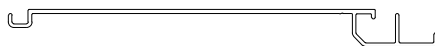

**KEC150S**  
Shadow Line Board - 150mm

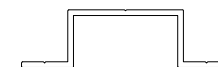

**KECT9025**  
Standard Profile - Top Hat - 90 x 25mm

### Disclaimer

The information in this technical detail is given as a guide and is intended for use in relation to the relevant Knotwood products only. The customer's project designer is ultimately responsible for special design and detailing to ensure the product's use is fit for purpose. The customer's project designer needs to give extra consideration to product suitability to take into account any specialised factors of the project. This specification detail must be reviewed in conjunction with the relevant Knotwood product installation guide current at the time of installation, and all other relevant Knotwood product technical literature.



## Top View - Detail

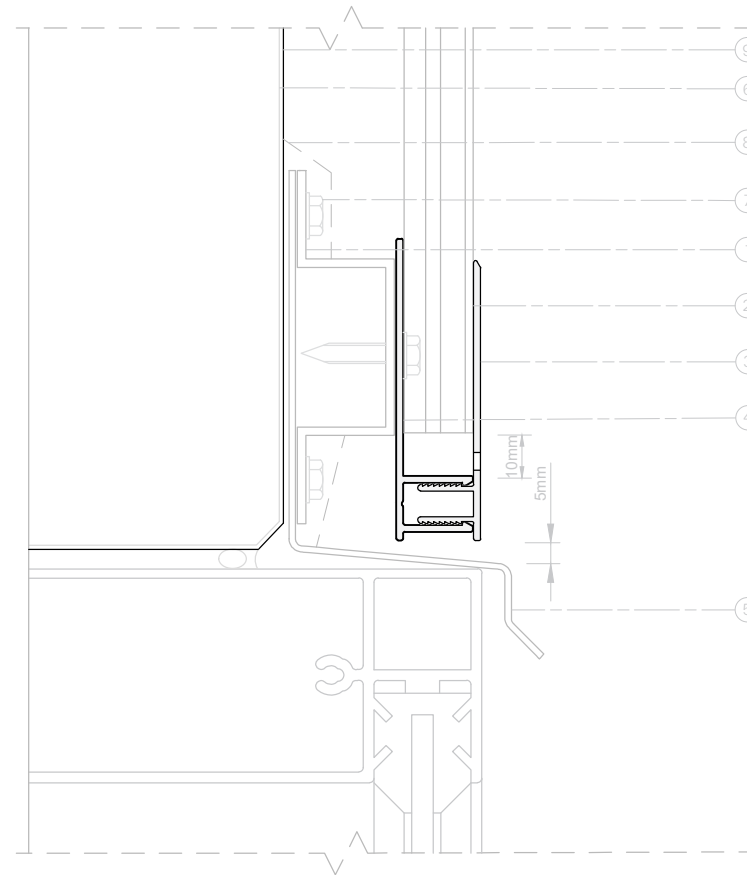

## Profiles



**KECFF**  
Base Trim - (F)

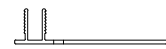

**KECFSML**  
Slotted Cover Trim - Large (M)



**KEC150S**  
Shadow Line Board - 150mm

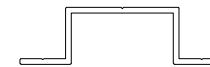

**KECT9025**  
Standard Profile - Top Hat - 90 x 25mm

# KNOTWOOD™

Detail Drawings Library

## INTERLOCKING BOARDS

Window Head Trim - Vertical  
Cladding

### References

#### Knotwood

- ① Standard Profile - Top Hat - 90 x 25mm - KECT9025
- ② Shadow Line Board - 150mm - KEC150S
- ③ Slotted Cover Trim - Large - (M) - KECFSML
- ④ Base Trim - (F) - KECFF

#### 3rd Party

- ⑤ Window Flashing (by other)
- ⑥ Building Substructure
- ⑦ #10 x 5/8" Hex Washer Head Self-Drilling Screws
- ⑧ Flexible Sealant Tape
- ⑨ Vapour Barrier / Building Envelope

### Drawing

Version: V-001  
Date: 01-Oct-2025

### Disclaimer

The information in this technical detail is given as a guide and is intended for use in relation to the relevant Knotwood products only. The customer's project designer is ultimately responsible for special design and detailing to ensure the product's use is fit for purpose. The customer's project designer needs to give extra consideration to product suitability to take into account any specialised factors of the project. This specification detail must be reviewed in conjunction with the relevant Knotwood product installation guide current at the time of installation, and all other relevant Knotwood product technical literature.

## Detail - Review

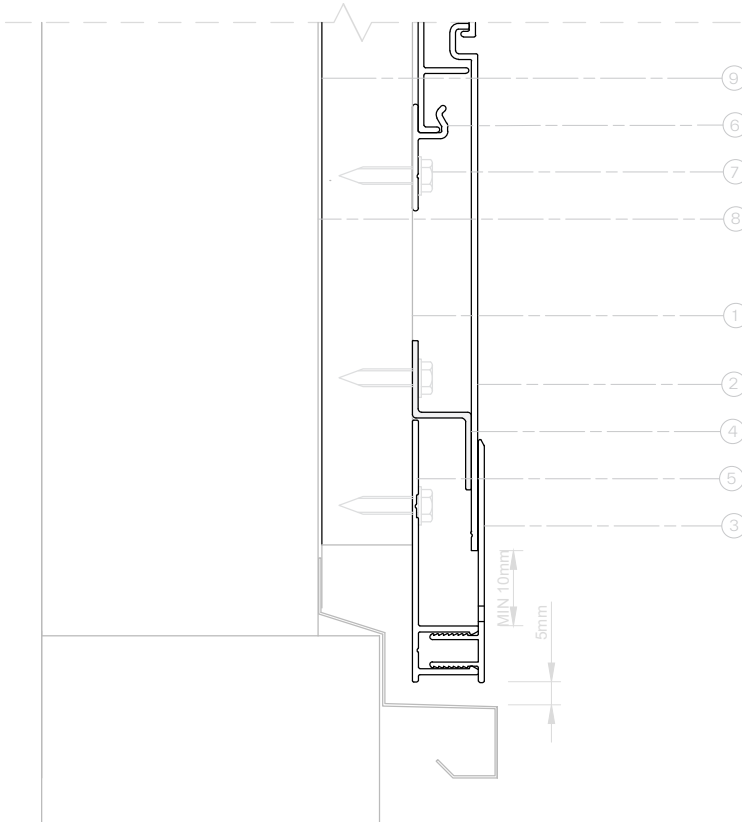

## Profiles



**KECSFF**  
Base Trim - (F)



**KECSFML**  
Slotted Cover Trim - Large - (M)



**KECSZ**  
Standard Profile - Z - 20mm

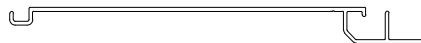

**KECS150S**  
Shadow Line Board - 150mm



**KECS9025**  
Standard Profile - Top Hat - 90 x 25mm

# KNOTWOOD™

Detail Drawings Library

## INTERLOCKING BOARDS

### Z Trim/Packer - Horizontal Cladding

## References

### Knotwood

- ① Standard Profile - Top Hat - 90 x 25mm - KECS9025
- ② Shadow Line Board - 150mm - KECS150S
- ③ Slotted Cover Trim - Large - (M) - KECSFML
- ④ Standard Profile - Z - 20mm - KECSZ
- ⑤ Base Trim - (F) - KECSFF
- ⑥ Cladding - Clip - 45mm - KACC

### 3rd Party

- ⑦ #10 x 5/8" Hex Washer Head Self-Drilling Screws
- ⑧ Building Substructure
- ⑨ Vapour Barrier / Building Envelope

## Drawing

Version:

V-001

Date:

01-Oct-2025

## Disclaimer

The information in this technical detail is given as a guide and is intended for use in relation to the relevant Knotwood products only. The customer's project designer is ultimately responsible for special design and detailing to ensure the product's use is fit for purpose. The customer's project designer needs to give extra consideration to product suitability to take into account any specialised factors of the project. This specification detail must be reviewed in conjunction with the relevant Knotwood product installation guide current at the time of installation, and all other relevant Knotwood product technical literature.

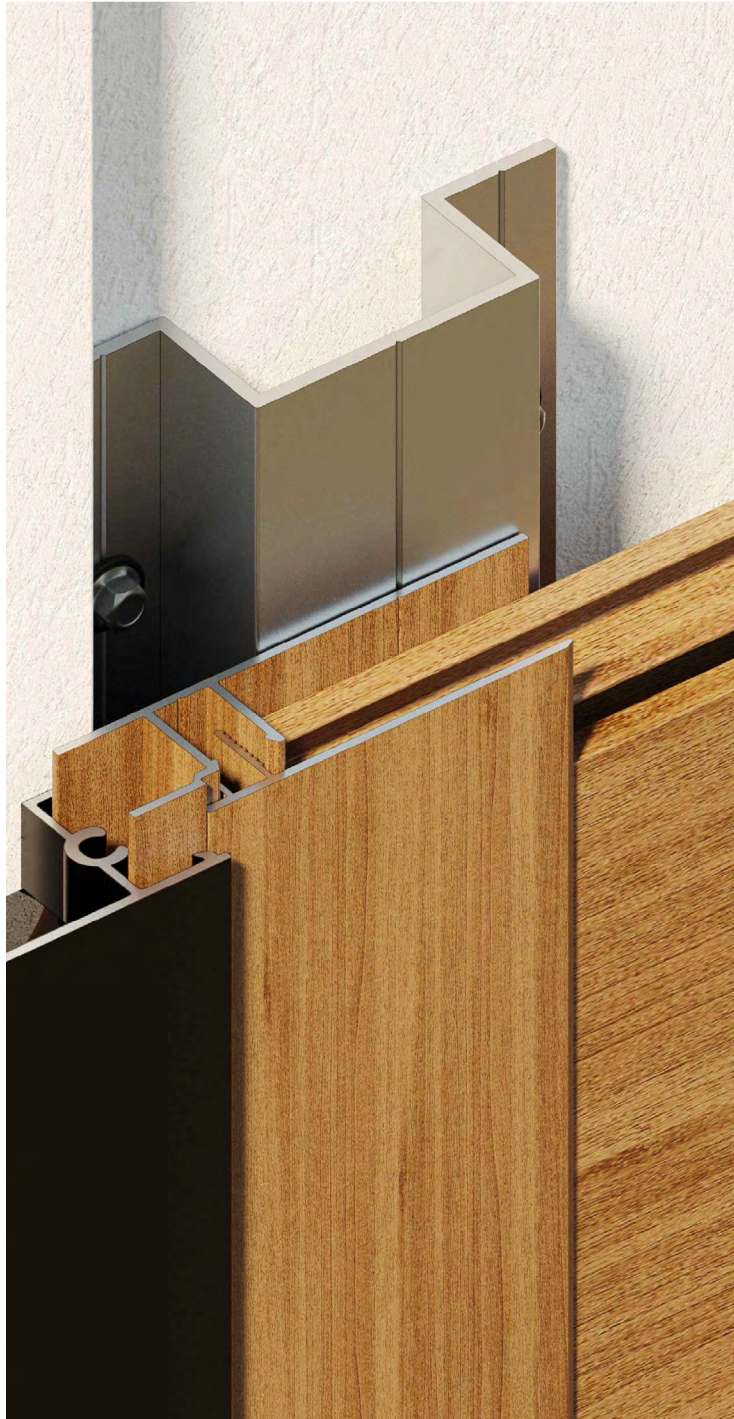

## Top View - Detail

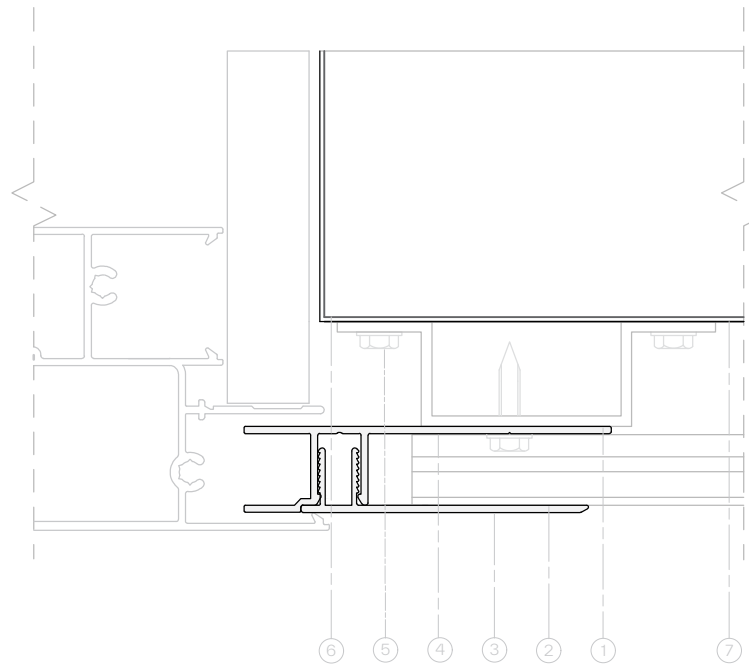

## Profiles



**KECWJF**  
Window Jamb Base Trim - (F)



**KECFML**  
Cover Trim - Large - (M)

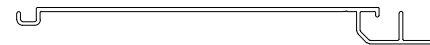

**KEC150S**  
Shadow Line Board - 150mm

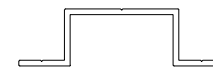

**KECT9025**  
Standard Profile - Top Hat - 90 x 25mm

# KNOTWOOD™

Detail Drawings Library

## INTERLOCKING BOARDS

Window Jamb Trim - Horizontal  
Cladding

### References

#### Knotwood

- ① Standard Profile - Top Hat - 90 x 25mm - KECT9025
- ② Shadow Line Board - 150mm - KEC150S
- ③ Cover Trim - Large - (M) - KECFML
- ④ Window Jamb Base Trim - (F) - KECWJF

#### 3rd Party

- ⑤ #10 x 5/8" Hex Washer Head Self-Drilling Screws
- ⑥ Building Substructure
- ⑦ Vapour Barrier / Building Envelope

### Drawing

Version: V-001

Date: 01-Oct-2025

### Disclaimer

The information in this technical detail is given as a guide and is intended for use in relation to the relevant Knotwood products only. The customer's project designer is ultimately responsible for special design and detailing to ensure the product's use is fit for purpose. The customer's project designer needs to give extra consideration to product suitability to take into account any specialised factors of the project. This specification detail must be reviewed in conjunction with the relevant Knotwood product installation guide current at the time of installation, and all other relevant Knotwood product technical literature.



## Detail - View

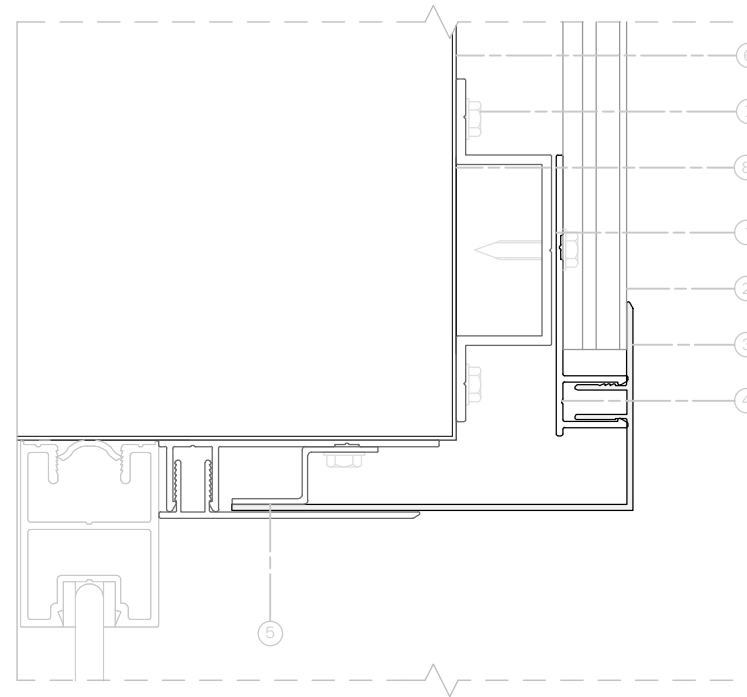

## Profiles

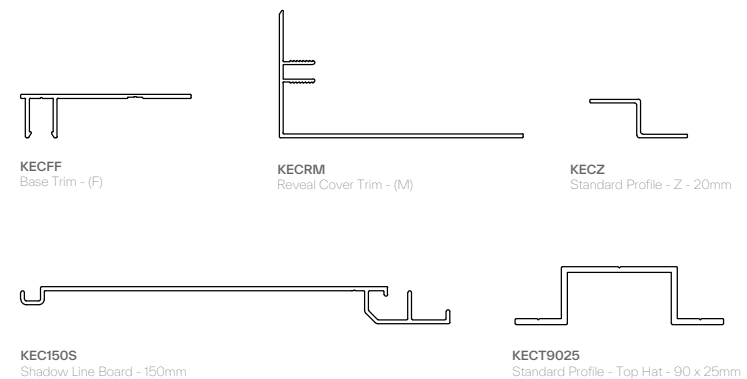

# KNOTWOOD™

Detail Drawings Library

## INTERLOCKING BOARDS

### Reveal Trim - Side View Horizontal Cladding

#### References

##### Knotwood

- ① Standard Profile - Top Hat - 90 x 25mm - KECT9025
- ② Shadow Line Board - 150mm - KEC150S
- ③ Reveal Cover Trim - (M) - KECRM
- ④ Base Trim (F) - KEFFF
- ⑤ Standard Profile - Z - 20mm - KECZ

##### 3rd Party

- ⑥ Building Substructure
- ⑦ #10 x 5/8" Hex Washer Head Self-Drilling Screws
- ⑧ Compliant Building Membrane

#### Drawing

Version: V-001  
Date: 01-Oct-2025

#### Disclaimer

The information in this technical detail is given as a guide and is intended for use in relation to the relevant Knotwood products only. The customer's project designer is ultimately responsible for special design and detailing to ensure the product's use is fit for purpose. The customer's project designer needs to give extra consideration to product suitability to take into account any specialised factors of the project. This specification detail must be reviewed in conjunction with the relevant Knotwood product installation guide current at the time of installation, and all other relevant Knotwood product technical literature.



## Top View - Detail

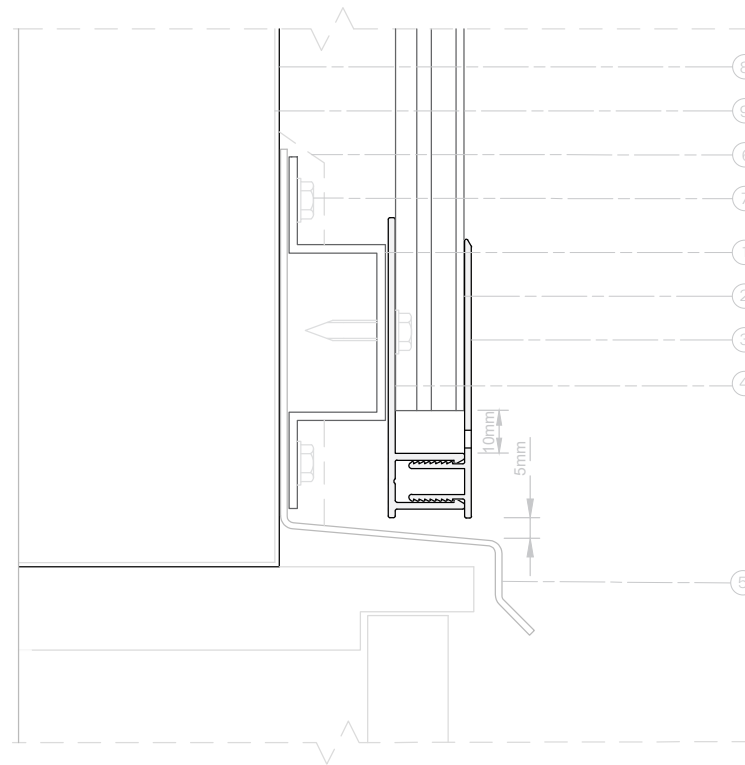

## Profiles



**KECFF**  
Base Trim - (F)



**KECFSML**  
Slotted Cover Trim - Large (M)



**KEC150S**  
Shadow Line Board - 150mm



**KECT9025**  
Standard Profile - Top Hat - 90 x 25mm

# KNOTWOOD™

Detail Drawings Library

## INTERLOCKING BOARDS

### Door Head Trim - Vertical Cladding

## References

### Knotwood

- ① Standard Profile - Top Hat - 90 x 25mm - KECT9025
- ② Shadow Line Board - 150mm - KEC150S
- ③ Slotted Cover Trim - Large - (M) - KECFSML
- ④ Base Trim - (F) - KECFF

### 3rd Party

- ⑤ Window Flashing (by other)
- ⑥ Building Substructure
- ⑦ #10 x 5/8" Hex Washer Head Self-Drilling Screws
- ⑧ Vapour Barrier / Building Envelope
- ⑨ Flexible Sealant Tape

## Drawing

Version: V-001

Date: 01-Oct-2025

## Disclaimer

The information in this technical detail is given as a guide and is intended for use in relation to the relevant Knotwood products only. The customer's project designer is ultimately responsible for special design and detailing to ensure the product's use is fit for purpose. The customer's project designer needs to give extra consideration to product suitability to take into account any specialised factors of the project. This specification detail must be reviewed in conjunction with the relevant Knotwood product installation guide current at the time of installation, and all other relevant Knotwood product technical literature.



## Detail - View

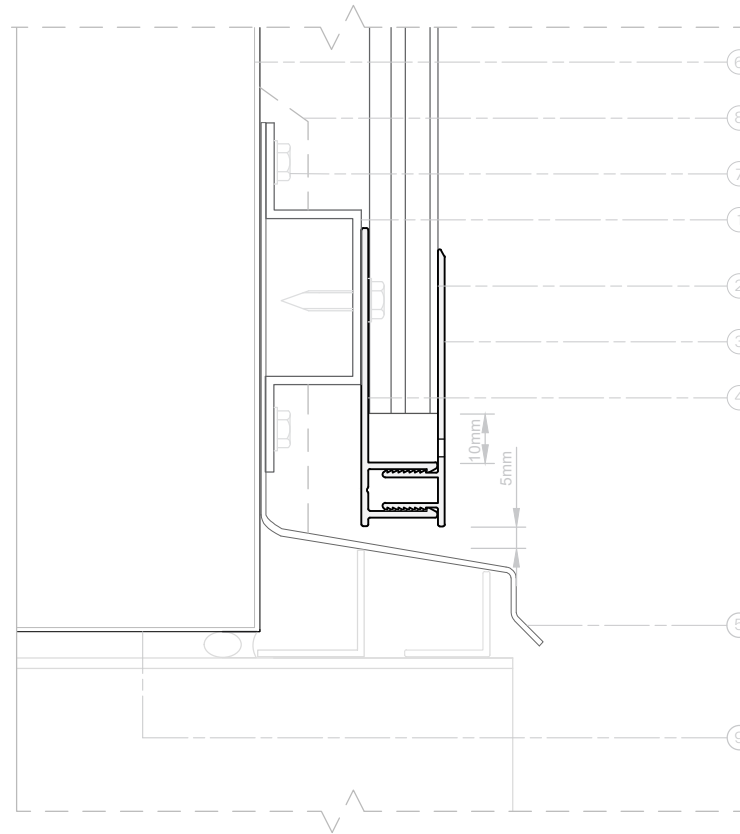

## Profiles



**KECFF**  
Base Trim - (F)



**KECFSML**  
Slotted Cover Trim - Large - (M)



**KEC150S**  
Shadow Line Board - 150mm



**KECT9025**  
Standard Profile - Top Hat - 90 x 25mm

# KNOTWOOD™

Detail Drawings Library

## INTERLOCKING BOARDS

### Service Utility Box Trim - Vertical Cladding

#### References

##### Knotwood

- ① Standard Profile - Top Hat - 90 x 25mm - KECT9025
- ② Shadow Line Board - 150mm - KEC150S
- ③ Slotted Cover Trim - Large (M) - KECFSML
- ④ Base Trim (F) - KECFF

##### 3rd Party

- ⑤ Construction Flashing (by other)
- ⑥ Building Substructure
- ⑦ #10 x 5/8" Hex Washer Head Self-Drilling Screws
- ⑧ Flexible Sealant Tape
- ⑨ Vapour Barrier / Building Envelope

#### Drawing

Version: V-001  
Date: 01-Oct-2025

#### Disclaimer

The information in this technical detail is given as a guide and is intended for use in relation to the relevant Knotwood products only. The customer's project designer is ultimately responsible for special design and detailing to ensure the product's use is fit for purpose. The customer's project designer needs to give extra consideration to product suitability to take into account any specialised factors of the project. This specification detail must be reviewed in conjunction with the relevant Knotwood product installation guide current at the time of installation, and all other relevant Knotwood product technical literature.

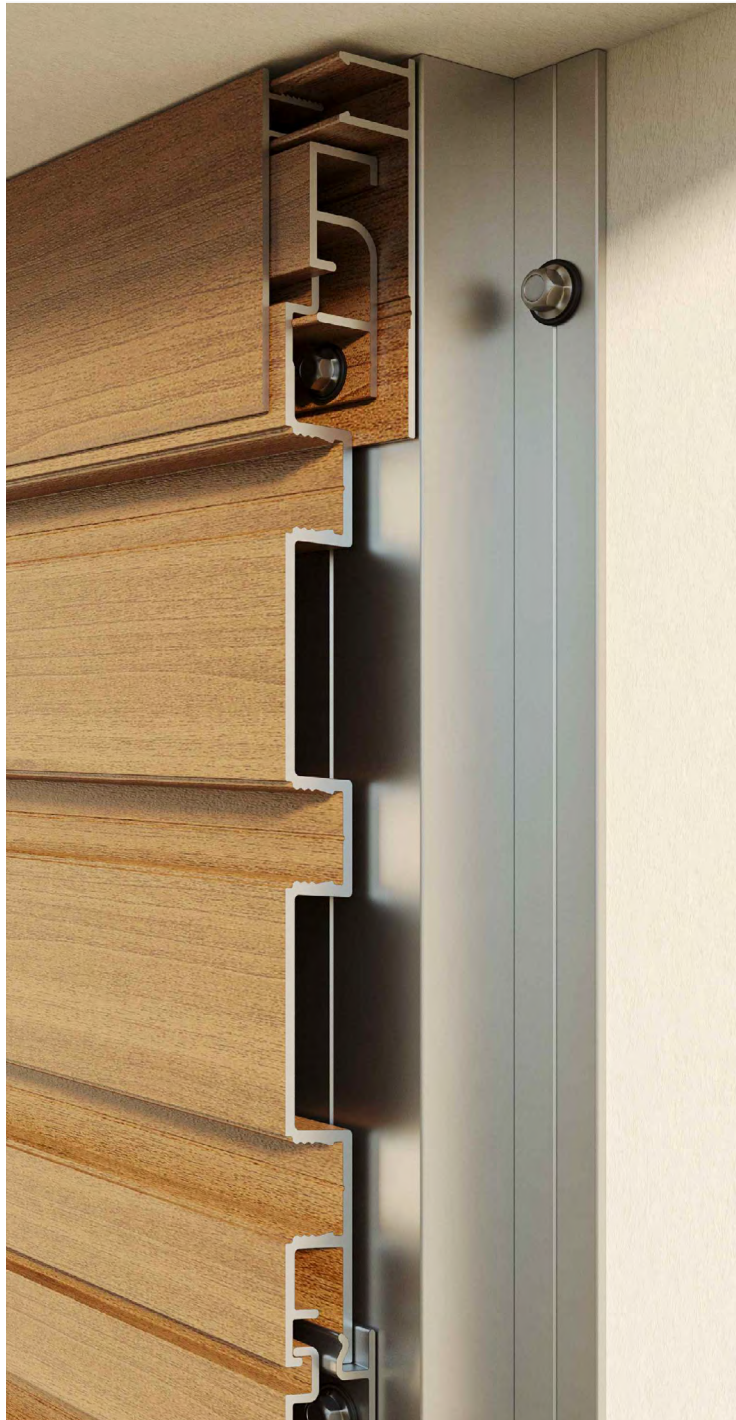

## Detail - Review

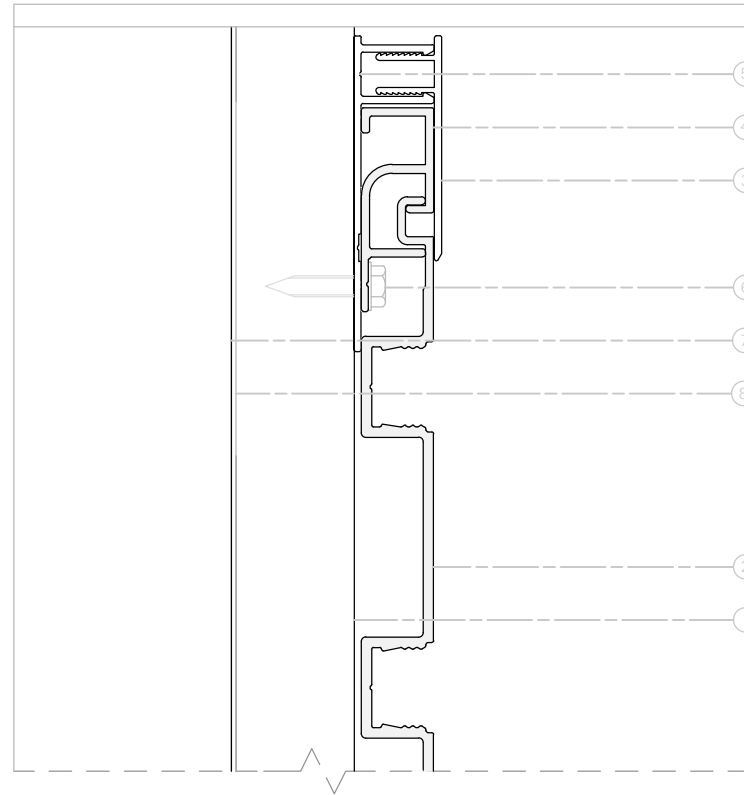

## Profiles



**KECFF**  
Base Trim - (F)

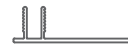

**KECFMM**  
Cover Trim - (M)



**KECDS**  
Dimensional Starter



**KECDIM200**  
Dimensional Board - 200mm



**KECT9025**  
Standard Profile - Top Hat - 90 x 25mm

# KNOTWOOD™

Detail Drawings Library

## INTERLOCKING BOARDS

Dimensional Starter Trim -  
Horizontal Cladding

### References

#### Knotwood

- ① Standard Profile - Top Hat - 90 x 25mm - KECT9025
- ② Dimensional Board - 200mm - KECDIM200
- ③ Cover Trim - (M) - KECFMM
- ④ Dimensional Starter - KECDS
- ⑤ Base Trim (F) - KECFF

#### 3rd Party

- ⑥ #10 x 5/8" Hex Washer Head Self-Drilling Screws
- ⑦ Building Substructure
- ⑧ Vapour Barrier / Building Envelope

### Drawing

Version: V-001

Date: 01-Oct-2025

### Disclaimer

The information in this technical detail is given as a guide and is intended for use in relation to the relevant Knotwood products only. The customer's project designer is ultimately responsible for special design and detailing to ensure the product's use is fit for purpose. The customer's project designer needs to give extra consideration to product suitability to take into account any specialised factors of the project. This specification detail must be reviewed in conjunction with the relevant Knotwood product installation guide current at the time of installation, and all other relevant Knotwood product technical literature.



## **Knotwood AU**

1 300 566 896

[sales@knotwood.com.au](mailto:sales@knotwood.com.au)

## **Knotwood US**

602 313 1641

[sales@knotwood.com](mailto:sales@knotwood.com)

## **Knotwood UK**

0800 131 3165

[sales@knotwood.co.uk](mailto:sales@knotwood.co.uk)

© KNOTWOOD Pty Ltd. All rights reserved.

Consultation with a qualified engineer or building professional is recommended to confirm the appropriate subframe orientation, fixing method, and corner detailing required for your specific project.

The information contained in this document is the intellectual property of KNOTWOOD Pty Ltd. and is protected by copyright and other intellectual property laws.